

Bedienungsanleitung / Manual: LED-Dimmer EV103225--/ EV103325--

Montage / Mounting

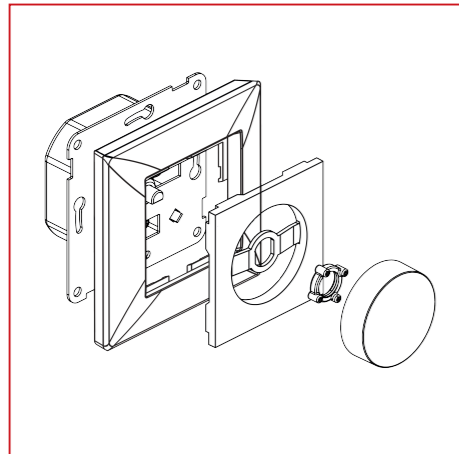

Anschlussplan / Connection diagram

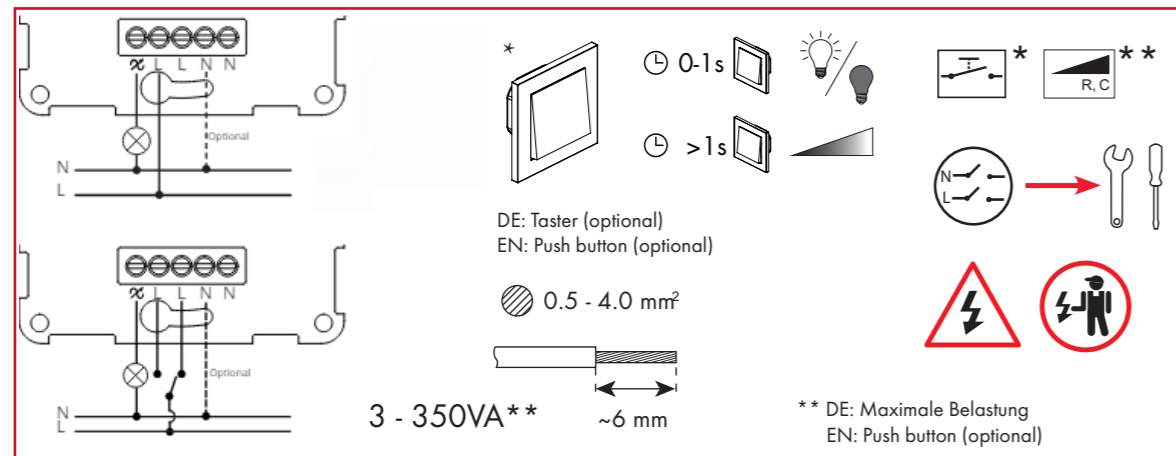

Anpassung der minimalen Dimmstufe
Minimum dimming level adjustment

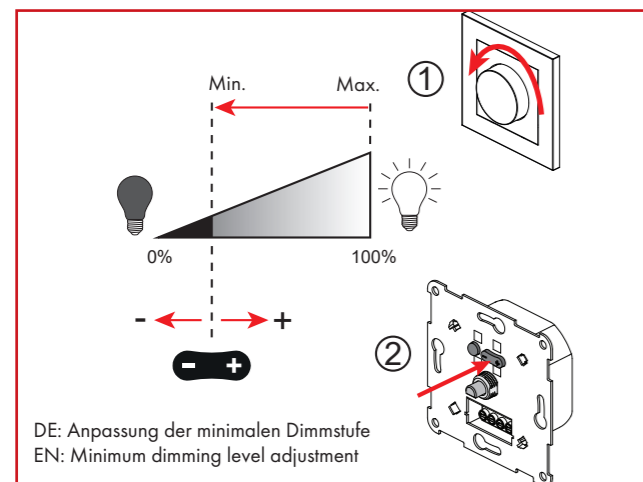

Zurücksetzen / Reset

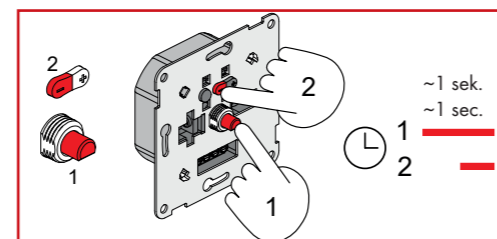

Technische Daten / Technical Data

Nennspannung / Nominal voltage: 220-240V, 50/60Hz
Betriebstemperatur / Operating temperature: 0-35°C
Maximale Last / Maximum load: 3-350VA
Belastungsarten / Load types: R, C

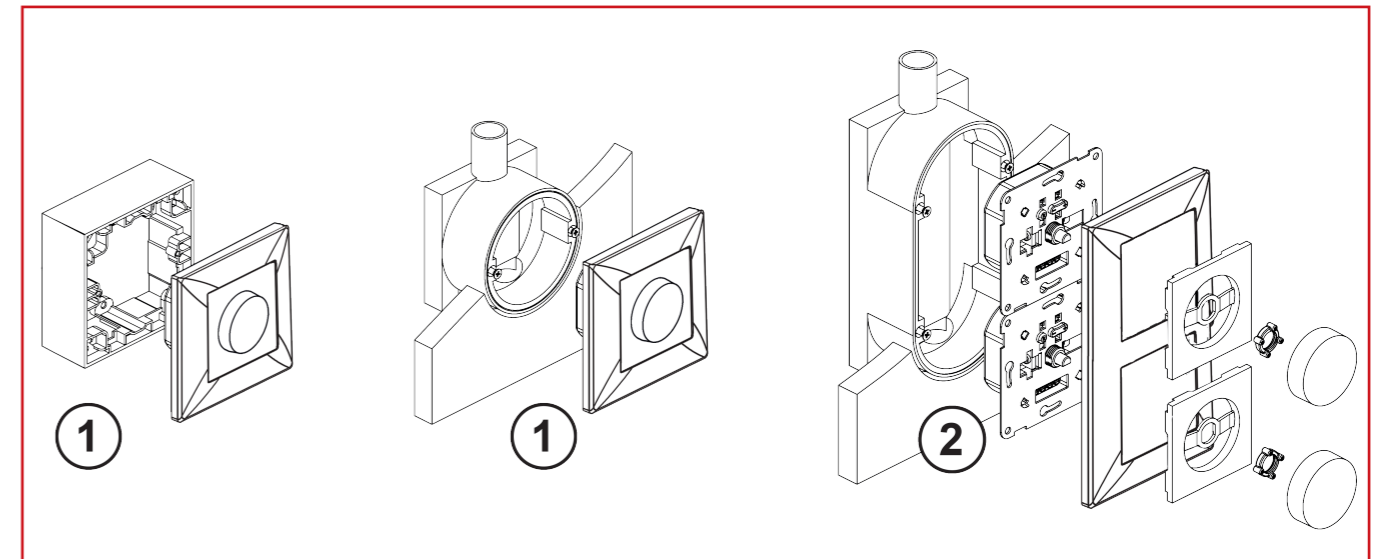
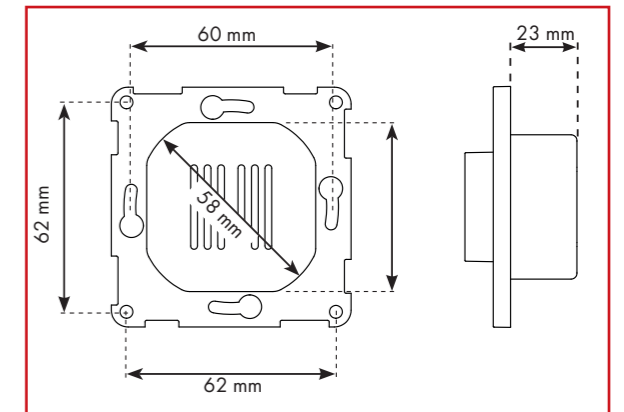

Belastungsart Load type	R	C	R+C	L
1 Ein Dimmer Single dimmer	max. 350W	max. 280VA	max. 280VA	✗
2 Zwei oder mehr Dimmer Two or more Dimmers	max. 260W/pc	max. 210VA/pc	max. 210VA/pc	✗

